

M材質	Inner Hardness	Surface Hardness	Heat Treatment
	I.H 內部硬度	S.H 表面硬度	熱處理
SKD61	HRC43 \pm 2°	HV1000 \pm 100°	氮化處理 Nitrided
SKH51	HRC52 \pm 2°	HRC52 \pm 2°	真空處理 Vacuumed
SKH51	HRC60 \pm 2°	HRC60 \pm 2°	真空處理 Vacuumed
SKD11	HRC60 \pm 2°	HRC60 \pm 2°	真空處理 Vacuumed

Type	先端形狀 Top shape	D 公差 Tolerance
JH010-1	S	+0.01 -0.02
	C	
	G	
JH010-2	T	0 -0.005
	R	
	B	

Catalog No.		Appoint 0.01mm unit			Appoint 0.1mm unit
Type	先端形狀 Top shape	H	L	D	T
JH010-1 JH010-2	S C G T R B	5	12.00~100.00	2.00~3.00	2.0~20.0 T ≤ L-10
		6		2.50~4.00	
		7		3.00~5.00	
		8		4.00~6.00	
		9		4.00~7.00	
		10		5.00~8.00	
		11		6.00~9.00	
		12		7.00~10.00	
		13		8.00~11.00	
		15		10.00~13.00	

●Order: Catalog No. \square D \times T \times A \times E \times \square 先端寸法 (K · S · G · Q)
Top size

備注: 1.圖面以外之特規格可定制。
Remark: Special product is available.

心型梢/各種訂制品 COREPINS/FORMED CORE PINS

塑膠模用

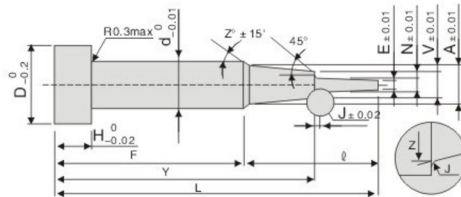
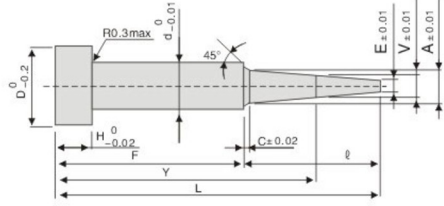
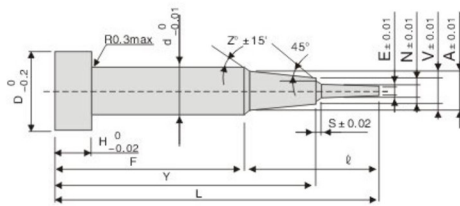

備注：依來圖加工另行報價。
Remark: The price is per the provided drawing.